

## 7. TECHNICAL DATA



	Baclyser™ IL3	Baclyser™ IL5	Baclyser™ IL10
Size	L 118 mm x ø 47 mm	L 150 mm x ø 61 mm	L 210 mm x ø 68 mm
Bacteria Retention	7 log steps <i>Brevundimonas diminuta</i>	7 log steps <i>Brevundimonas diminuta</i>	7 log steps <i>Brevundimonas diminuta</i>
Pore Size	0.2 µm (microfiltration)	0.2 µm (microfiltration)	0.2 µm (microfiltration)
Flow volume*	3,000 Litres	13,000 Litres	56,000 Litres
Chlorine resistance**	≤ 10 ppm	≤ 10 ppm	≤ 10 ppm
Flow rate (at 5 bar, 20°C)	13 l/min	22 l/min	30 l/min
Max. operating pressure	5 bar	5 bar	5 bar
Operating temperature***	≤ 40°C	≤ 40°C	≤ 40°C
Connection	Variant S: G½", screw thread AG Variant P: Push-fit quick- release coupling Ø 8 mm	Variant S: G½", screw thread AG Variant P: Push-fit quick- release coupling Ø 8 mm	Variant S: G½", screw thread AG Variant P: Push-fit quick- release coupling Ø 8 mm

\* Guide value recorded at a flow rate of 6 l/min. and mains water quality at 5 bar; user-specific water quality, pressure conditions and the requisite flow rate have an influence on the flow volume and filter operating time.

\*\* Continuous dosage of ≤ 10 ppm over operating time; short-term (1h) high dosage (400,00 ppm h) for chemical disinfection.

\*\*\* Application with higher temperatures only after consultation with Aqua free.

## 8. STORAGE

Baclyser filters must be stored in conditions that are dry, hygienic and protected from heat.

## 9. PRODUCT LABELING



Manufacturer



Do not use if  
package is  
damaged



Medical device



Use by



Batch code



Store dry



Consult  
instructions for use



Non-sterile



Dispose in with  
regular garbage

Aqua free is EN ISO 13485 certified.



**Distributed by AquaMedix LLC**

7169 Shady Oak Rd.  
Eden Prairie, MN 55344  
www.aquamedix.net | info@aquamedix.net  
Phone: 952-479-0636  
EPA Est. No. 89767-MN-001  
instl\_rev121818\_AQM

**Headquarters:**

**Aqua free GmbH**

Hamburg, Germany

**E-mail: [info@aquamedix.net](mailto:info@aquamedix.net)**

# Aqua free

## Instructions for use

### Baclyser™ IL3, IL5, IL10



- Inline hollow fiber membrane filter for medical, commercial and domestic water hygiene



Gebh.Anw.-Baclyser IL-GB-07/2016-V001



## 1. Product

Baclyser® IL filters are CE-marked medical devices.

They have been developed specifically for inline installation in the water supply pipes for a variety of applications. These filters provide effective protection against contamination using microfiltration which delivers a 7 log retention of waterborne pathogens from the water supply network.

The filters are available in three sizes IL3, IL5 and IL10 each with a choice of two connection options: push-in (P) or screw thread (S).

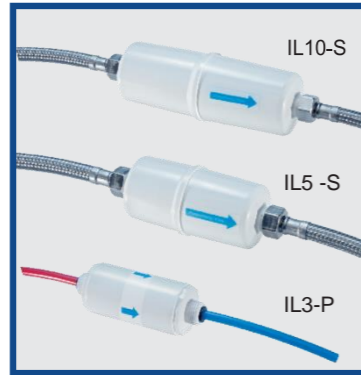

### Connection examples:

*Note: The connecting pipes illustrated are not supplied with the product as standard.*

## 2. Preparing for installation

- Turn off the water supply to the equipment.
- Cut open the water supply pipe at the point at which the filter is to be installed. Be careful of any water still in the pipe.
- Install suitable connections (connection pipes/adapters). Install an additional isolation valve if necessary.

### Note for version with P (push-in) adapter:

- Push red hose (accessory) or existing Ø 8mm hose/pipe into the push-in quick-release adapter (on the inflow side of the filter) up to the stop.
- Insert blue hose (accessory) into the push-in quick-release adapter (on the outflow side of the filter) up to the stop.
- Check the connection by pulling against it (secure the connection with an additional safety clip if necessary).



## 3. Installation of the filter

**Caution:** Before installing the filter check that the equipment and the water supply pipes are absolutely clean. This can be done by decontaminating the equipment and by decontaminating or replacing the hoses and similar parts.

**Note:** Disinfect your hands and put on disposable gloves before fitting the filter. Disinfect the outside of the connecting parts with alcohol-based surface disinfectant. Use only filters in original packaging.

- Take the filter out of the packaging ensuring that the outlet remains free of contamination.
- When installing the filter, be sure to take note of the direction of flow (see flow direction arrow).

### 3.1 Installation of filters with P adapter

- Push the inflow side of the filter onto the previously installed red hose or the existing Ø 8mm hose/pipe up to the stop.
- Push the outflow side of the filter onto the previously installed blue hose up to the stop.
- Check the connection by pulling against it (secure the connection with additional safety clips if necessary).
- After installation is complete, turn on the water supply and check for any leaks and that the application operates correctly with the filter in place.

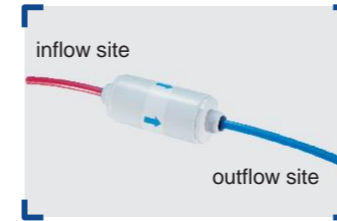

**Note:** When the push-fit adaptor type is fitted the G½" screw thread cannot be used as an adapter option!

### 3.2 Installation of filters with S adapter

- Screw the G½" retainer nut of the supply hose onto the inflow side of the filter; make sure that sealing gaskets are intact.
- Screw the G½" retainer nut of the outflow hose onto the outflow side of the filter; make sure that sealing gaskets are intact.
- After installation is complete, turn on the water supply and check for any leaks and that the application operates correctly with the filter in place.



## 4. Operation

- If a particular application requires a specific operating time, take note of this to determine the interval between changes of filter. Otherwise the filter should always be changed when the flow of water is reduced so much that it is no longer adequate or, at latest, 6 months after installation. The flow volumes given in the Technical Data table are indicative only and dependent on user-related water consumption and water quality.
- It is recommended to document filter changes by writing the next change date on a sticker and fixing that to the filter where it is easily visible.
- For cleaning the outside of the filter housing can be wiped with normal surface disinfectant.
- It is recommended that the water supply to the filter be turned off during long periods of disuse and that the system be checked regularly for leakage while in use.
- Protect installed filters from frost.
- See Technical Data table for maximum operating pressure and water temperature.
- Do not connect after pressure less waterheaters.

*If the product deviates from the specifications it should be sent back to Aqua free with a detailed Defect Report form (available to download at [www.aqua-free.com](http://www.aqua-free.com)).*

## 5. Removal and change of filter

**Note:** Disinfect your hands and put on disposable gloves before removing the filter.

- Turn off water supply
  - Disconnect the filter connections (first on inflow side, then on outflow side of filter)
- Caution:** Remaining water runs out (catch it in a bag or container). Do not allow the hose connections to become contaminated.

### Note for P adapter:

Unfasten by pressing the holding element against the connector.

- Dispose of the used filter correctly.
- Install new filter as described in section 3.

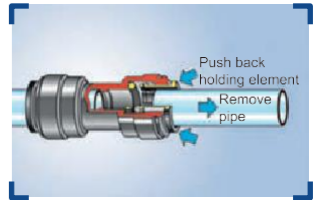

## 6. Accessories

Accessories are not supplied as standard.

The following accessories can be ordered/supplied separately depending on the adapter.

- For P adapter: Ø 8mm connection hoses (red & blue), connection adapter, isolation valves, safety clips

Details and additional accessories available on request.



### Distributed by AquaMedix LLC

7169 Shady Oak Rd.  
Eden Prairie, MN 55344  
[www.aquamedix.net](http://www.aquamedix.net) | [info@aquamedix.net](mailto:info@aquamedix.net)  
Phone: 952-479-0636  
EPA Est. No. 89767-MN-001